

FINAL PLAT

SCALE 1" = 40'
 DATE 7/21/82
 DRAWN BY FRANK FUCHSBERGER
ASHBERRY FARMS
SECTIONS 6A, 7A, 8A, 9A & 10
 6TH CIVIL DISTRICT, MADISON COUNTY, TENNESSEE
 TAX MAP 2, PARCELS 2810 - 2820 BOOK 65A, PAGE 15
 ZONE R-4 (MEDIUM DENSITY RESIDENTIAL DISTRICT)
 SECTION 6A - 110.0 ACRES
 SECTION 7A - 110.0 ACRES
 SECTION 8A - 110.0 ACRES
 SECTION 9A - 110.0 ACRES
 SECTION 10 - 110.0 ACRES

DRINK NO. 285-0847A

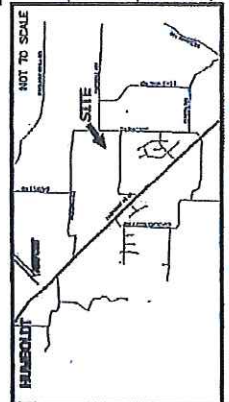

ERIC BURT
 DEED BOOK 570, PAGE 435
 TAX MAP 2, PARCEL 27.00

APPROVED BY JAMES TURNER
 MADISON COUNTY
 PLANNING COMMISSION
 DATE 7/21/82

JAMES TURNER
 DEED BOOK 570, PAGE 435
 TAX MAP 2, PARCEL 22.00

MULLINS ROAD - 50' R.O.W.

FUTURE DEVELOPMENT

FUTURE DEVELOPMENT

FUTURE DEVELOPMENT

FUTURE DEVELOPMENT

MULLINS ROAD - 50' R.O.W.

CLOVERWOOD COVE - 40' R.O.W.

OLIVEWOOD COVE - 40' R.O.W.

FROSTWOOD COVE - 40' R.O.W.

PENNSYLVANIA COVE - 40' R.O.W.

GARDEN GATE DRIVE - 50' R.O.W.

ASHBERRY LANE - 50' R.O.W.

ASHBERRY FARMS
 SECTION II
 PLAT BOOK 9, PAGE 39

ASHBERRY FARMS
 SECTION III
 PLAT BOOK 9, PAGE 40

ASHBERRY FARMS
 SECTION IV
 PLAT BOOK 9, PAGE 41

ASHBERRY FARMS
 SECTION V
 PLAT BOOK 9, PAGE 42

ASHBERRY FARMS
 SECTION VI
 PLAT BOOK 9, PAGE 43

ASHBERRY FARMS
 SECTION VII
 PLAT BOOK 9, PAGE 44

ASHBERRY FARMS
 SECTION VIII
 PLAT BOOK 9, PAGE 45

ASHBERRY FARMS
 SECTION IX
 PLAT BOOK 9, PAGE 46

ASHBERRY FARMS
 SECTION X
 PLAT BOOK 9, PAGE 47

ASHBERRY FARMS
 SECTION XI
 PLAT BOOK 9, PAGE 48

ASHBERRY FARMS
 SECTION XII
 PLAT BOOK 9, PAGE 49

ASHBERRY FARMS
 SECTION XIII
 PLAT BOOK 9, PAGE 50

ASHBERRY FARMS
 SECTION XIV
 PLAT BOOK 9, PAGE 51

ASHBERRY FARMS
 SECTION XV
 PLAT BOOK 9, PAGE 52

ASHBERRY FARMS
 SECTION XVI
 PLAT BOOK 9, PAGE 53

ASHBERRY FARMS
 SECTION XVII
 PLAT BOOK 9, PAGE 54

ASHBERRY FARMS
 SECTION XVIII
 PLAT BOOK 9, PAGE 55